

**The Brooklyn**  
 111 Lawrence Street  
 Downtown Brooklyn  
**718-246-0111**  
[www.thebrooklyner.com](http://www.thebrooklyner.com)  
[rent@thebrooklyner.com](mailto:rent@thebrooklyner.com)

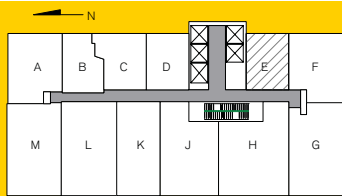

A CLARETT GROUP DEVELOPMENT  
 Equity Residential

**STUDIO**  
 1 BATH  
 475 SQ. FT.



**5-41E**

All dimensions are approximate and subject to construction variances. Plans and dimensions may contain minor variations from floor to floor.

